

# Profile M 40x40x4 E natural

**Product number** PI-1415 SN3000  
**Weight** 1.02kg  
**Length** 2000mm

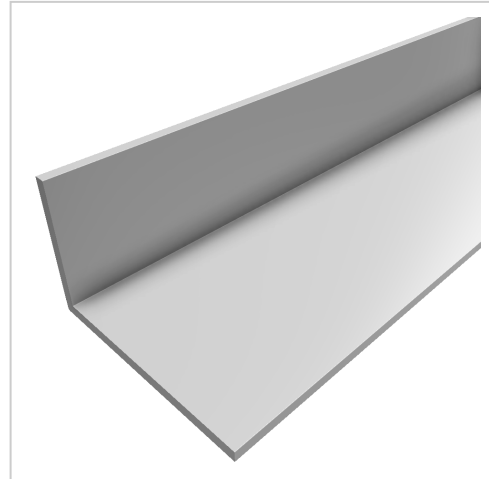

## Product description

Angle and flat profiles can be used in a variety of ways, e.g. for edging panel elements, as end or support strips, etc.

Delivery length 2000 mm

Compatible with item 7.0.002.7

## Product properties

**Size** 40x25 mm  
**Material** Al Mg Si 0.5 F25, artificially aged  
**Anodised** E6EV1 10-15 µm silver  
**Tolerances** EN 12020-2  
**Breite Profil** 40 mm  
**Höhe Profil** 25 mm  
**Contour** Angle  
**Delivery unit** Rods  
**Series** Series 8  
**Groove shape** 4 sides closed  
**Profile length** 3000 mm bar  
**Colour** natural  
**Execution** economy

## More images

