

# Threaded Rod for Swivel Feet VA M12x150, stainless

**Product number** ZB-3185

**Weight** 0.13kg

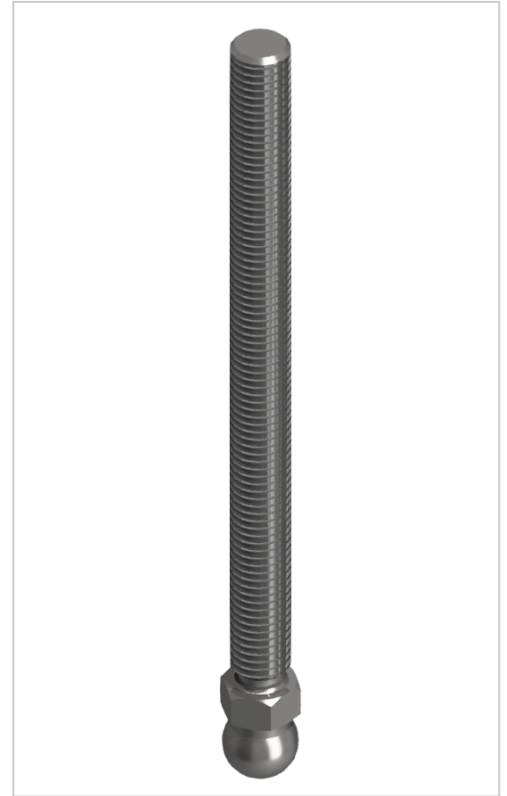

## Product description

The combination of a threaded rod and a swivel foot plate gives a complete adjustable foot. Leveling feet serve as any type stepless height and level adjustment of modules and racks. The tilt of the plate is variable. Optionally, a rubber insert can be installed.

## Product properties

**Compatible with** Bosch

**Part type** levelling feet

**Series** Series 60-10, Series 45-10, Series 50-10, Series 40-10, Series 30 8, Series 20-6

**Length** 150 mm

**Thread** M12

**Execution** stainless steel

More images

