

Threaded Rod for Swivel Feet ST M12x150, bright zinc-plated

Product number ZB-3184

Weight 0.13kg

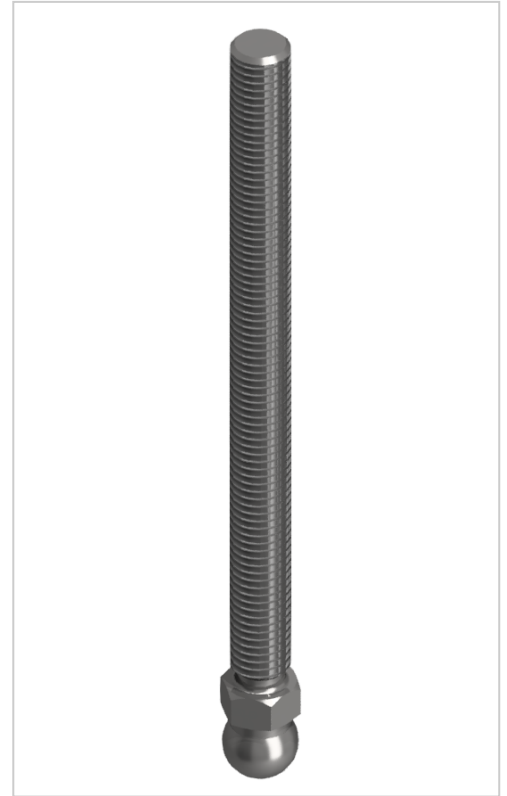

Product description

The combination of a threaded rod and a swivel foot plate gives a complete adjustable foot. Leveling feet serve as any type stepless height and level adjustment of modules and racks. The tilt of the plate is variable. Optionally, a rubber insert can be installed.

Product properties

Compatible with Bosch

Series Series 60-10, Series 45-10, Series 50-10, Series 40-10, Series 30 8, Series 20-6

Length 150 mm

Material Galvanized steel

Thread M12

More images

