

# Profile 80x120 light natural-10

**Product number** PB-1170 SZ

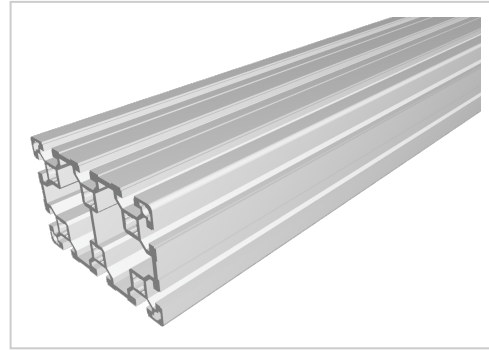

## Product description

The profiles in pitch 40 with groove 10 are suitable for assemblies of all kinds. Due to the different profile geometries, the material requirements can be adapted to the application. The grooves are designed for M8 screws.

Cut to size max. 6000 mm

Compatible with Bosch 3 842 993 201

## Product properties

<b>Compatible with</b>	Bosch
<b>Nutauszugskraft</b>	F=7.000 N
<b>Breite Profil</b>	120 mm
<b>Höhe Profil</b>	80 mm
<b>Groove shape</b>	Open grooves
<b>Profile length</b>	Cut length
<b>Modular dimension</b>	Modular dimension 40
<b>Delivery unit</b>	Cuts
<b>Execution</b>	light
<b>Contour</b>	Rectangular
<b>Series</b>	Series 40-10
<b>Colour</b>	natural
<b>Size</b>	120x80 mm

More images

